

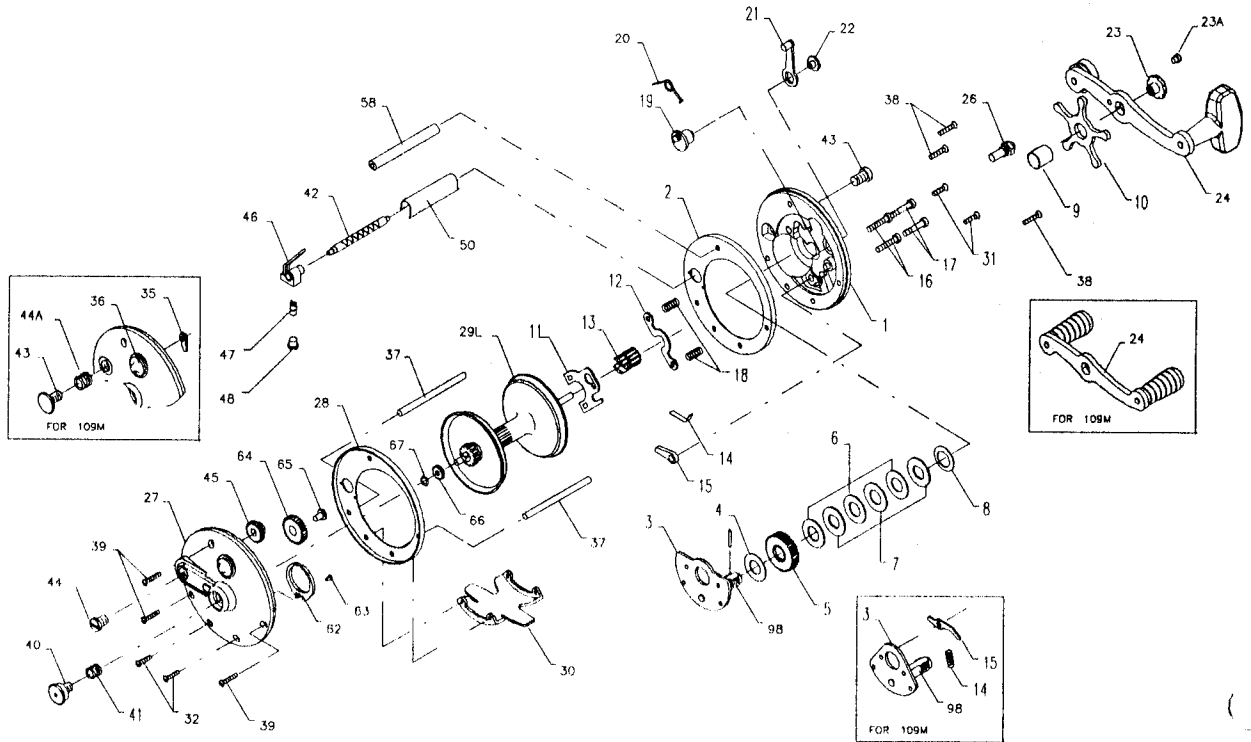

PARTS AND PRICE LIST FOR MODELS 9 AND 109



Key No.	Part No.	Description	Price	Key No.	Part No.	Description	Price
1	001 009	Right Side Plate	\$5.25	27	027 009	Left Side Plate	\$7.80
	001 109	Right Side Plate	5.40		027 109	Left Side Plate	6.00
2	002 109	Right Side Ring	2.85	28	028 109	Left Side Ring	2.85
3	003 009	Bridge w/Sleeve	6.00	29L	029L009	Spool (Aluminum)	14.85
	003 109	Bridge w/Sleeve	4.50		029L109	Spool (Aluminum)	14.85
4	004 155	Fiber Washer	.45	30	030N009	Stand	6.00
5	005 109	Main Gear	4.00	32	032 002	Stand Screw (4 req.)	.40
6	006 155	Drag Washer-HT100	.60	35	035 155	Click Tongue	1.00
7	007C155	Washer (Metal Set)	2.55	36	036 060CH	Click Button (9)	1.10
8	008 060	Tension Spring	.50		036 109	Click Button (109)	.95
9	009 060	Spacing Sleeve	.90	37	037 109	Frame Post (2 req.)	1.65
10	010 180	Star Drag	2.50	39	039 001	L.S. Post Screw (6 req.)	.40
11	011 009	Eccentric Jack (9)	1.25	40	040 109	L.S. Bearing	2.25
12	012 009	Pinion Yoke (9)	.90	41	041 109	L.S. Bearing Spring	.75
13	013 009	Pinion Gear	3.00	42	042 109	Worm	2.55
	013 109	Pinion Gear	2.80	43	043 009	Right Side Worm Bearing	1.60
14	014 009	Dog Spring	.40		043 109	Right Side Worm Bearing	1.60
	014 109	Dog Spring	.50	44	043 109	Left Side Worm Bearing (9)	1.60
15	015 009	Dog	.90		044N109	Left Side Worm Bearing (109)	1.70
	015 109	Dog	.90	44A	057 109	Worm Bearing Spring (109)	.65
16	016 009	Lower Bridge Screw (2 req.)	.45	45	045 009	Worm Gear (9)	1.75
	016 060	Lower Bridge Screw (2 req.) (109)	.45		045 109	Worm Gear (109)	1.75
17	017 009	Upper Bridge Screw (2 req.) (9 only)	.45	46	046 009	Line Guide	2.70
18	018 009	Clutch Spring (9)	.45		046 109	Line Guide	2.70
19	019 009	Eccentric	2.00	47	047 109	Pawl	.65
	019 109	Eccentric	2.00	48	048 109	Pawl Cover	.80
20	020 109	Eccentric Spring	.45	50	050 109	Worm Shield	1.25
21	021 109	Eccentric Lever	1.60	58	058 109	Slotted Post	1.95
22	022 109	Eccentric Screw	.55	62	062 209	Click Spring (9)	1.50
23	023 060	Handle Screw (9)	1.75	63	063 209	Click Spring Screw (9)	.50
	023 180	Handle Screw (109)	1.50	64	064 009	Idler Gear (9)	1.75
23A	110 060	Handle Lock Screw (9)	.45	65	065 209	Idler Gear Screw (9)	.50
24	024 160	Handle (9)	7.00	66	066 009	Level Wind Drive Gear (9)	1.50
	024 109	Handle	5.00	67	067 009	Drive Gear Lock Spring (9)	.40
26	026 009	Right Side Bearing	2.05	98	098 155	Gear Sleeve	3.50
	026 109	Right Side Bearing	2.05				